

Häfele Slido Classic 20 IF K

Pin or roller guided

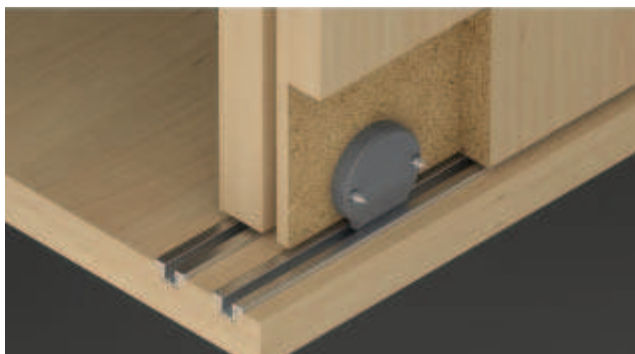
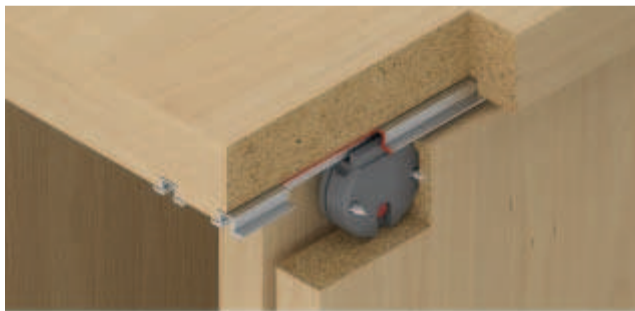

- > Door thickness: Min. 16 mm
- > Height adjustment: ±1.5 mm on running gear

Drilling pattern

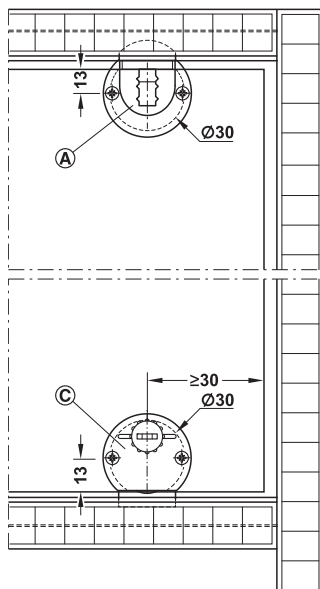

- (A) Guide with lockable bolt
- (C) Running gear with height adjustment

Installation dimensions

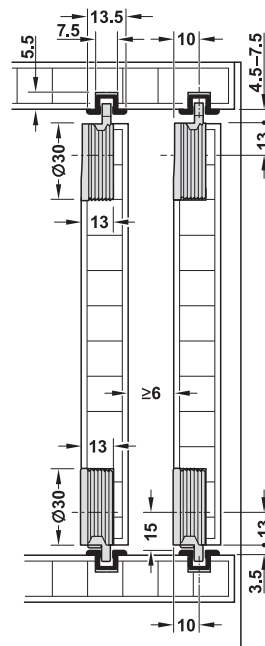

Single top and bottom running and guide track, running gear with height adjustment

→ **Guide**
With lockable bolt

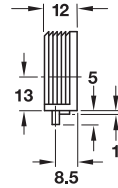
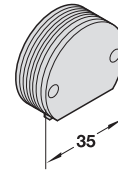

- > Material: Plastic
- > Version: With bolt, locks at 5 and 8 mm
- > Installation: For press fitting

Colour	Cat. No.
Grey	404.19.320

Packing: 1 piece

→ **Running gear**
With height adjustment

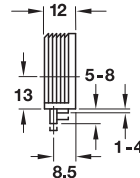
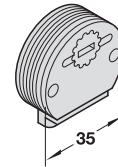

- > Height adjustment: With adjustable spindle
- > Material: Running gear: Plastic, roller: Polyamide
- > Installation: For press fitting

Colour	Cat. No.
Running gear: Grey, roller: White	404.20.340

Packing: 1 piece

→ **Single top and bottom running and guide track**

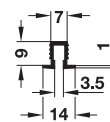

- > Material: Plastic
- > Version: With flanged edges and harpoon rib
- > Length: 3 m
- > Installation: For press fitting and gluing into groove

Colour	Cat. No.
Brown	404.14.133
White	404.14.713
Black	404.14.313
Silver coloured	404.14.913

Packing: 1 piece

DGH-M-INT 2020, HDE-en, 05/19, Dimensional data not binding. We reserve the right to alter specifications without notice.

